

Worm Wheel Geared Motor 蜗轮蜗杆减速机

WG5 Series

General Specification

Gearbox Housing 齿轮箱壳体	Ruggedised Die-cast Aluminium 强化压铸铝
Worm Gear Material 蜗轮蜗杆材料	Bronze, steel or plastic 青铜, 钢, 塑料
Lubrication 润滑方式	Grease lubricated & sealed for life 油脂润滑并且密封
Bearing Type 轴承类型	High quality ball bearings 高质量滚珠轴承
Insulation Class 绝缘等级	Class F (Optional: Class B) Class F (Class B 可供选择)
Brush Type 碳刷类型	Integral or removable 一体型或可替换型
Ambient Operating Temperature 环境工作温度	-20°C to +40°C

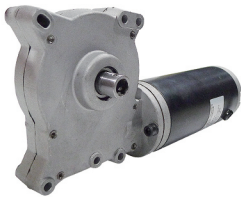

Performance Data

Motor Type: 电机类型	73ZYT Series		
Motor Length: 电机长度	159.6	159.6	mm
Rated Voltage: 额定电压	24	240	VDC
Rated Speed 额定转速	550	550	± 10% rpm
Rated Power 额定功率	560	600	W
Gear Ratio 减速比	10:1	10:1	
Motor Torque 电机扭矩	1.2	1.2	Nm
Motor Speed 电机转速	5500	5500	± 10% rpm
Duty Cycle 工作周期	2 to 3 seconds on, 2 to 5 minutes off.		

Dimensions in mm

